

WORLD ATHLETICS
INDOOR CHAMPIONSHIPS
BELGRADE 22

TEAM MANUAL

(as at 25/02/2022)



WORLD ATHLETICS PARTNERS



WORLD ATHLETICS MEDIA PARTNER



WORLD ATHLETICS SUPPLIERS

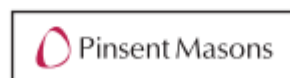

CONTENTS

- 1 GENERAL INFORMATION
 - 1.1 World Athletics Council Members & International Officials
 - 1.2 Local Organising Committee
 - 1.3 General Programme
- 2 TRAVEL TO BELGRADE
 - 2.1 Official Airport and Arrival Information
 - 2.2 Entry Visas
 - 2.3 Insurance
- 3 ACCREDITATION
 - 3.1 Accreditation Centre
 - 3.2 Accreditation Procedures and Payments
 - 3.3 Quota and Financial Support
 - 3.4 Arrivals Outside Accreditation Centre Opening Times
 - 3.5 Special Passes
 - 3.6 Loss of Accreditation Card
- 4 ACCOMMODATION
 - 4.1 Team Hotels
 - 4.2 Team Hotels Costs
 - 4.3 Team Hotels Check-in Procedures
 - 4.4 Services in the Team Hotels
 - 4.5 Meals
- 5 TRANSPORT
 - 5.1 Airport
 - 5.2 Competition and Training Venues
 - 5.3 Final party
 - 5.4 Travel times
- 6 INFORMATION CENTRES
 - 6.1 Technical Information Centre (TIC)
 - 6.2 Competition Information Desks (CID)
 - 6.3 WA Competitions Department Offices
 - 6.4 Documents Distribution
- 7 COMPETITION FACILITIES, EQUIPMENT AND IMPLEMENTS
 - 7.1 Main Stadium - Stark Arena
 - 7.2 Warm-up Area
 - 7.3 Training Venue
 - 7.4 Training at the Competition Venue
 - 7.5 Sports Equipment
 - 7.6 Markers
 - 7.7 Official Implements
- 8 ENTRIES AND FINAL CONFIRMATIONS
 - 8.1 Entry Rules
 - 8.2 Age Categories
 - 8.3 Entry Standards
 - 8.4 Final Entries
 - 8.5 Final Confirmations
- 9 COMPETITION PROCEDURES
 - 9.1 Orientation Visit for Team Leaders and Coaches

- 9.2 Technical Delegates Availability
- 9.3 Timetable
- 9.4 Athletes' Bibs
- 9.5 Athletes' Clothing
- 9.6 Personal Belongings
- 9.7 Call Room Procedures
- 9.8 Track Events
- 9.9 Field Events
- 9.10 Coaching Zones
- 9.11 Timing and Measurement
- 9.12 Post Competition Procedures
- 9.13 Medal Ceremonies
- 9.14 Protests and Appeals
- 9.15 Competition Awards
- 10 MEDICAL SERVICES
- 11 DOPING CONTROL
- 12 MOWA INDOOR ATHLETICS HERITAGE EXHIBITION
- 13 OFFICIAL MERCHANDISE
- 14 APPENDICES AND MAPS

1. GENERAL INFORMATION

1.1 World Athletics Council Members and International Officials

WORLD ATHLETICS COUNCIL

President	Sebastian COE (GBR)
Senior Vice-President	Sergey BUBKA (UKR)
Vice-Presidents	Geoff GARDNER (NFI)
	Nawaf AL SAUD (KSA)
	Ximena RESTREPO (COL)
Individual Members	Alberto JUANTORENA DANGER (CUB)
	Nawal EL MOUTAWAKEL (MAR)
	Abby HOFFMAN (CAN)
	Dahlan AL HAMAD (QAT) – Asia*
	Hamad KALKABA MALBOUM (CMR) – Africa*
	Anna RICCARDI (ITA)
	Sylvia BARLAG (NED)
	Hiroshi YOKOKAWA (JPN)
	Antti PIHLAKOSKI (FIN)
	Adille SUMARIWALLA (IND)
	Nan WANG (CHN)
	Willie BANKS (USA)
	Raul CHAPADO (ESP)
	Dobromir KARAMARINOV (BUL)
	Beatrice AYIKORU (UGA)
	Mike SANDS (BAH) – NACAC*
	Hélio GESTA DE MELO (BRA) – South America*
	Robin Sapong EUGENIO (NMI) – Oceania*
	Renaud LAVILLENIE (FRA) – Athletes' Commission Chairperson
	Valerie ADAMS (NZL) – Athletes' Commission Representative

**Area representative*

International Officials

Technical Delegates	Niels VAN DER AAR (NED)
	Luca VERRASCINA (ITA)
Jury of Appeal	Abby HOFFMAN (CAN)
	Chris COHEN (GBR)
	Antonio PEREZ CRISTOBAL (ESP)
Secretary of the Jury of Appeal	Pierce O'CALLAGHAN (IRL)
Medical Delegate	Stéphane BERMON (FRA)
Anti-Doping Delegate	Jasmina GLAD-SCHREVEN (FIN)
Press Delegate	Martina KUCEROVA (SVK)
Statistician	Andras SZABO (HUN)
English Announcer	Kris TEMPLE (GBR)
Advertising Commissioner	Karena VLECK (GBR)
Photo Commissioner	Raquel CAVACO NUNES (POR)
International Starter	Lisa FERDINAND (CAN)
Int'l Photo Finish Judge	David WEICKER (CAN)
ITOs	Rui LOUCAO (POR) - Chief
	Giovanni CARDONA GOMEZ (COL)
	Gemma CASTANO VINYALS (ESP)
	Daniel MICHAUD (CAN)
	Loreto PEREZ ROMAN (ESP)

1.2 Local Organising Committee (LOC)

LOC President

WIC22 CEO

WIC22 CEO Assistant

Administration

Finance

Competition

IT

Transportation

Accommodation

Medical

Hospitality

Protocol

Communications & Media Operations

Marketing

Ticketing

Accreditation

Venue

Logistics & Customs

Team Service

Event presentation Manager

Volunteers

LOC Competitions Team

Competition Director

Competition Director Deputy

Meeting Manager

Meeting Manager Deputy

Technical Manager

Technical Manager Deputy

Competition Secretary

TIC Manager

NTO Coordinator

Chief Marshal

Competition Administrator

BRANKOVIĆ Slobodan

MOMIROVIĆ Predrag

MITRIĆ Danijela

KANTAR Jovan

KRSMANOVIĆ Ivan

RISTOV Marko

BILANOVIĆ Nikola

BOJČIĆ Milan

MOZETIĆ Jelena

ČIKIRIZ Nikola

BRANKOVIĆ Tanja

ILIĆ Vladimir

ŽIVKOVIĆ Dušan

ĆIRILOVIĆ Milan

ŠOŠEVIĆ Nataša

POPADIĆ Marko Security

KNEŽEVIĆ Bogdan

KOSOJEVIĆ Radomir

MATIĆ Petar

PIPER Predrag

ŽIVIĆ Petar

SMILJANIĆ Mina

RISTOV Marko

TRIFUNAC Goran

ACIĆ ZARIĆ Milena

ĆULIBRK Isidora

MILOSAVLJEVIĆ Goran

PETOŠEVIĆ Vladimir

KALIČANIN Bojana

REPIĆ ĆUJIĆ Vesna

ZDRAVKOVIĆ Nebojša

STIBILJ Aleksandar

JAKŠIĆ Andrijana

1.5 GENERAL PROGRAMME

Wednesday, 16 March	All day	Team Arrivals and Accreditation
Thursday, 17 March	09:15	Stadium Tour
Friday, 18 – Sunday 20 March		World Athletics Indoor Championships
Monday, 21 March	All day	Team Departures

2. TRAVEL TO BELGRADE

2.1 Official Airport and Arrival Information

Airport Nikola Tesla Belgrade is the official Airport.

Arrival in Belgrade should primarily be on Wednesday 16 March. Those teams planning to arrive prior to 16 March and/or leave after 21 March, are advised to contact the LOC well in advance to check availability of accommodation and transport arrangements.

Please note that there is no official transport from any other airport.

After leaving the plane, teams and officials will go through passport control. After collecting your luggage, please proceed to the World Athletics Indoor Championships welcome desk. From there you will be escorted to the official vehicle and taken to your hotel.

Vaulting poles

Vaulting poles will be transferred from the airport directly to the Training venue. Be sure to arrange travel on airlines that are able to transport your vaulting poles.

LOC contact person is Aleksa Simić: aleksa.simic@wabelgrade22.com

2.2 Entry Visas

Detailed entry visa information was circulated to Member Federations in November 2021. The list of countries requiring a visa can be found in Appendix E of the Circular Letter M/44/21.

2.3 Insurance

All member federations are responsible for their own insurance to cover illness or injury to any member of their delegation or team, when travelling to and from World Athletics events and during the event.

Circular M/03/22 specifically dedicated to team insurance coverage for emergency medical costs during the travel and stay abroad for all athletes and officials at 2022 World Athletics Series competitions was issued on 17 January 2022.

3. ACCREDITATION

3.1 Accreditation Centre

The Team Accreditation Centres (TAC) will be located in :

- Crowne Plaza Hotel (meeting room Pacific)
- Radisson hotel (M3 room)
- Mona Plaza hotel (Schonda 4 room)

Opening Dates and Times :

- TAC Radisson hotel and Mona Plaza hotel:

14 March	08:00 – 13:00 / 14:00 – 20:00
15 March	08:00 – 13:00 / 14:00 – 20:00
16 March	08:00 – 13:00 / 14:00 – 20:00
17 March	08:00 – 13:00 / 14:00 – 20:00
18 March	09:00 – 13:00
- TAC Crowne Plaza

15 March	08:00 – 13:00 / 14:00 – 20:00
16 March	08:00 – 13:00 / 14:00 – 20:00
17 March	08:00 – 13:00 / 14:00 – 20:00
18 March	09:00 – 13:00 / 14:00 – 17:00
19 March	09:00 – 13:00 / 14:00 – 17:00

WA/LOC Administrative Office

- 15 March 13:30 – 19:00
- 16 March 09:00 – 13:00 / 14:00 – 20:00
- 17 March 09:00 – 13:00 / 14:00 – 20:00
- 18 March TBC

3.2 Accreditation Procedures and Payments

Team Leader

The Team Leader will have to report to the WA / LOC Office at the accreditation centre before collecting his card in order to complete the following formalities:

- LOC Accommodation Invoice
- Travel Reimbursement
- WA Financial Statement
- Final Confirmation of Entries
- Bibs and Special Passes Collection
- Uniform Check

The Team Leader will be asked to complete the accounting procedures and settle any extra payments (for team members above quota, use of single rooms, extra days, etc.) before collecting the accreditation card, which will be given upon the presentation of a document stating all procedures have been completed.

To shorten procedures and avoid delays, it is strongly advised to settle payment prior to arriving in Belgrade. The LOC Finance Team will get in contact with all teams about settling their accommodation invoice in advance of their arrival.

3.3 Quota and Financial Support

The financial Quota by Member Federation, and the financial support offered by WA / LOC, was detailed in the WA M44/21-Circular Letter. The Quota chart can be found in Appendix D.

3.4 Athletes and Team Officials

After having completed stage 2 of the Medical Clearance Protocol (see Covid-19 Protocol), all athletes and team officials will also need to report individually to the Team Accreditation Centre to collect their accreditation card. An ID (e.g. passport) will be required to collect the accreditation card.

Team Leaders will need to complete the administrative procedure at the World Athletics and LOC office (see above 3.2) before proceeding to the Team Accreditation Centre to be issued with their accreditation. Teams or individual athletes arriving outside the Accreditation Centre opening dates and times will be accompanied to their allocated hotel (the LOC will ensure to make the necessary arrangements according to the arrival schedule announced in the Final Entries), after having completed stage 2 of the Medical Clearance Protocol (see Covid-19 Protocol)

3.5 Special Passes

WA shall provide special passes as required for the following categories:

- Combined Events Rest Room (two per athlete for coach and physiotherapist)
- TIC pass

3.6 Loss of Accreditation Card

Personal accreditation badge must be worn around the neck, with the individual photo and name clearly visible, at all times in all public spaces, and must be presented upon request. They are personal and non-transferable. The loss or theft of an accreditation card must be reported immediately to the accreditation centre or Competition Information Desk in the hotel. In order to obtain new accreditation, the person in question, accompanied by the team leader and carrying an appropriate identification document, must request it personally.

Any Accreditation Card found being used by someone who is not its owner will be confiscated and its owner will be subject to sanction including possible ineligibility for his competitive participation in the Competition.

4. ACCOMMODATION

4.1 Team Hotels

The LOC has arranged accommodation for all participants in 4* hotels:

HOTEL NAME	ADDRESS AND WEBSITE
Crowne Plaza Belgrade	Vladimira Popovica 10, 11070 Belgrade https://www.ihg.com/crowneplaza/hotels/us/en/belgrade/begcp/hoteldetail
Falkensteiner Hotel Belgrade	Bulevar Mihajla Pupina 10k, 11070 Belgrade https://www.falkensteiner.com/en/hotel-belgrade
Mona Plaza hotel	Cara Urosa 62, 11000 Belgrade https://www.monaplaza.com/
Radisson Collection hotel, Old Mill Belgrade	Bulevar vojvode Misica, 11000 Belgrade https://www.radissonhotels.com/en-us/hotels/radisson-collection-old-mill-belgrade
IN hotel Belgrade	Bulevar Arsenija Carnojevic 56, 11070 Belgrade https://www.inhotel-belgrade.rs/en

Accommodation contact persons: Jelena Mozetić and Predrag Piper

Email: accommodation@wabelgrade22.com

jelena.mozetic@wabelgrade22.com

4.2 Team Hotels Cost

For all athletes in the quota the LOC will offer free accommodation in twin rooms during the official period (arrival on Wednesday, 16 March – departing on Monday, 21 March), for a maximum of five nights. Single rooms will be charged a supplement as detailed below.

All Prices per person per day - Full Board	Official Period Check-in 16 March / Check-out 21 March (5 nights)		Outside Official Period	
	Twin	Single	Twin	Single
Athletes in quota	Paid by LOC	40 USD	140 USD	180 USD
Athletes above quota and All Team Officials	120 USD	160 USD		
Extra Officials (above 55%)	140 USD	180 USD		

The number of officials that can be accommodated with the team at subsidised rates will be limited to a quota corresponding to 55% of the athletes (see chart in Appendix). An additional 25% of non-subsidised officials (up to an overall maximum of 80%) will be accommodated in the Team hotels subject to availability.

The accommodation invoices will be based on the information (number of persons and arrival / departure details) provided in the final entries, with a tolerance of two people.

Payment of extra costs can be made:

- By credit card: MasterCard or Visa
- In cash: US Dollars, Euros, Serbian Dinar

- In advance: Bank transfer – please contact Jelena Mozetic
 - Email: Jelena.mozetic@wabelgrade22.com

4.3 Team Hotels Check-in Procedures

Team Leader must report to the LOC Accommodation Desk, which will be located in the hotel's main reception area, to complete the check in procedure. The accommodation team will confirm the rooming list as previously provided by the Member Federation in Event Entry System (see Circular 49/21) and then issue the room keys. All team members must have a valid identification document (passport or identity card) to check-in.

Once checked in, the Team Leader will be directed to the 'WA/LOC Administrative Office' to settle payment. Once payment has been settled the Team Leader can collect his/her accreditation.

If other hotel services are required, the individual must scan the credit card at the main reception desk to activate these extra services (telephone, laundry, room service, etc.).

4.4 Services in the Team Hotels

Accommodation Desk

For questions related to check in, hotel registration and local transport the LOC accommodation team will be happy to assist you. Please contact them on accommodation@wabelgrade22.com

Meeting Rooms

Rooms for meetings are available at team hotels. Rooms can be reserved via the Accommodation Desk.

Rooms for Physiotherapy

Rooms for physiotherapy will be available at both team hotels. Rooms can be reserved via Accommodation Desk.

Internet access

Wi-Fi will be available in all hotels

4.5 Meals

Athletes and team officials will be admitted to the meal service area in the team hotel upon presentation of their accreditation cards and meal vouchers. However, access to this area will only be possible in the hotel where they are staying. Meals will all be served in buffet style and will be similar in all hotels. Hotels will cater for religious and special dietary requirements and all food shall be appropriately labelled in English. Mealtimes during the official period shall be as follows:

- Breakfast: 06:00 – 10:00
- Lunch: 12:00 – 16:00
- Dinner: 19:00 – 00:00

5. TRANSPORT

5.1 Airport

Travel from Airport Nikola Tesla Belgrade (BEG) to the Team Hotels takes approximately 30 minutes.

Transport will be organised according to the arrival schedule announced in the Final Entries. Please remember to indicate in your Entries whether you will be arriving with poles, physio beds or any other bulky luggage so that the LOC can make the necessary transportation arrangements. A welcome desk will be located in front of the arrivals gate.

5.2 Competition and Training Venue

LOC will provide transport between the teams' hotels and the Stark Arena (with the exception of IN hotel Belgrade which is 3min walking distance) as well as to and from the training venue. Detailed schedules will be posted in the official information points of the Championships (CIDs and TIC)

5.3 Travel Times

Below are the approximate times and distances between the key locations.

	Airport Nikola Tesla Belgrade (BEG)		Competition Venue		Training Venue	
	Distance	Travel time	Distance	Travel time	Distance	Travel time
Crowne Plaza Belgrade	17.3km	19min	2km	5min	5.8km	10min
Falkensteiner Hotel Belgrade	15.2km	18min	1.6km	5min	8.8km	13min
Mona Plaza hotel	20.2km	28min	4.8km	14min	6.6km	18min
Radisson Collection hotel, Old Mill Belgrade	18.1km	19min	4.1km	7min	3.9km	8min
IN hotel Belgrade	15.4km	17min	600m	3' walking	6.6km	13min

6. INFORMATION CENTRES

6.1. Technical Information Centre (TIC)

The Technical Information Centre is located at the main competition venue, on the 4th floor / Level 400, by the Teams stands.

The main task of the TIC is to ensure a smooth liaison between each delegation and the Local Organising Committee, the WA Technical Delegates and the Competition Management of the Championships regarding technical matters.

The TIC is responsible for, but not limited to, the following:

- Displays on the relevant notice board of official communications to the teams, including start lists, results and call room reporting times. These will also be displayed at the warm-up area.
- Distribution of urgent notices to the delegations from the Technical Delegates and competition management via the pigeonholes. It is the Team Leader's duty to collect this kind of information.
- Distribution of coaches' seating passes/tickets for field events
- Receipt of relay order confirmations
- Receipt of written appeals.

This will be the main centre for technical information although certain documents produced in the TIC will also be distributed to the CIDs in team hotels for circulation.

The TIC will open on Wednesday 16 March. The TIC's opening hours are:

Wednesday, 16 th March	10:00-13:00 / 15:00-18:00
Thursday, 17 th March	9:00-13:00 / 15:00-19:00
Friday, 18 th March	8:30-21:30
Saturday, 19 th March	8:30-22:30
Sunday, 20 th March	9:00-21:30

6.2. Competition Information Desks (CID)

There will be a CID in all Team Hotels, which will be linked to the TIC. It will be responsible for, but not limited to, the following:

- Display relevant notices and official communications to the teams, including start lists, results and call room reporting times.
- Distribution of urgent notices to the delegations from the technical delegates and competition management. It is the Team Leader's duty to collect this kind of information in due time.
- Receipt of enquiries concerning the Championships (deadline 20.00 on Wednesday 16 March).
- Receipt of final confirmations.
- It will also be possible to submit general enquiries to the TIC through these CIDs.
- Distribution of information and answering queries relating to accommodation, meals, transport and the Championships in general.

CIDs will be open from 16 to 21 March from 08:00 to 22:00

There will be a reduced CID service prior to 15 March, for teams that arrive earlier.

6.3 WA Competitions Department Offices

Staff from the WA Competitions Department will be in Belgrade to assist the LOC with the final preparation and conduct of the Championships and the teams with their participation.

They can be contacted as follows:

15 to 17 March	WA Administrative Office at Crowne Plaza Hotel
18 to 20 March	WA Competitions Office at the Stadium – can be contacted through the TIC

6.4 Document Distribution

The distribution of competition related information at the TIC and CIDs will NOT be systematically made through printouts in the team pigeonholes but will be displayed on the notice boards (and also available at the warm-up area).

It will still be possible to request occasional copies of specific event start lists and / or results (at the TIC).

Important notices of general interest (e.g. changes to the timetable) will also be displayed on the notice board.

The pigeonholes will be used to share individual communications with specific teams.

7. COMPETITION FACILITIES, EQUIPMENT AND IMPLEMENTS

7.1 Main Arena

The Championships will take place at Belgrade Štark Arena, which is situated in close proximity to the team hotels..

The facility has:

- 6 lanes, 0.90m wide/lane, 200m oval track ()
- 8 lanes, 60m straight ()
- One high jump site
- One pole vault site
- One long/triple jump site
- One Shot Put site
- The part of the spike which projects from the sole or the heel shall not exceed 9mm.

7.2 Warm-up Area

The warm-up area will be situated in in the same building as the main arena of the Championships. It will be equipped as follows:

- 10-lane, 40m straight ()
- hurdles, starting blocks
- synthetic surface to allow for jogging
- Shot put circle
- Long jump/Triple jump (30m runway)
- Weightlifting area
- Team medical/physio area

The entrance to the warm-up area is adjacent to the team drop-off point at Belgrade Stark Arena. It will be available every day from 7:30 until one hour after the last event.

The access will be granted only to those athletes competing in the running session of the Timetable.

7.3 Training Venue

Teams will have access to Athletic Indoor Hall – 4 lanes at 200m oval track, 8 lanes at 60m straight, one shot put site, one long jump / triple jump site, one high jump site, one pole vault site. The Gym and training equipment will be provided. There will be a regular bus service to and from Team Hotels.

Training venue working hours:

TUESDAY 15 March	10:00-13:00 / 15:00-18:00
WEDNESDAY 16 March	10:00-13:00 / 15:00-18:00
THURSDAY 17 March	10:00-13:00 / 15:00-18:00
FRIDAY 18 March	10:00-13:00 / 15:00-18:00
SATURDAY 19 March	10:00-13:00 / 15:00-18:00
SUNDAY 20 March	10:00-13:00

LOC representatives will be available at the training venue to assist. Athletes are advised to follow the instructions given by the representative and to pay particular attention to safety rules during the training sessions.

Implements, equipment (hurdles, starting blocks, shots and relay batons will be available to athletes and coaches at the official training venue. These can be obtained from the equipment storage and athletes/coaches using the equipment will be asked to leave their accreditation card with the LOC representative in charge.

7.4 Training at the Competition Venue

Athletes will also be given the opportunity to train on the Field of Play (FOP) from 08:30 to 10:45 on Thursday 17 March.

A training session with the official starters will be held between 09:00 and 10:30 on Thursday 17 March.

7.5 Sports Equipment

All competition equipment will be provided by World Athletics Official Supplier, Mondo.

7.6 Markers / Tape Measure

Athletes will not be permitted to use their own markers or tape measure during the Championships. Athletes who wish to use a marker or tape measure must use those provided by the LOC. These are available at the event site. Tape measure will be in cm.

7.7 Allocation of Team tents

Team tents will be near the teams' drop-off point outside warm up facility. Entrance to the warm-up is possible only through the team tent. Team boxes will be allocated inside the team tent. Allocation of the team boxes will be made for each day of the competition and will be communicated in advance via TIC/CID. Only teams with competing athletes on that day will be permitted to use team tent and the access to warm up area will be granted only to those athletes competing in the running session of the Timetable.

7.7 Official Implements

MEN				
Catalogue No.	Company	Description	Colour	Certification No.
SHOT 7.26kg				
QQ-4	Jiangsu Jinling Sports	Jinling iron, dia: 120mm	Silver	I-12-0558
F251C	NISHI	Steel, dia: 129mm	Silver	I-99-0083
F251	NISHI	Steel, dia: 125.5mm	Silver	I-99-0087
PK-7,26/128	Polanik	Steel, dia: 128mm	Various	I-04-0305

WOMEN				
Catalogue No.	Company	Description	Colour	Certification No.
SHOT 4kg				
QQ-10	Jiangsu Jinling Sports	Jinling , iron, dia: 106mm	Silver	I-12-0554
F253C	NISHI	Steel, dia: 109mm	Silver	I-99-0084
F253	NISHI	Steel, dia: 103mm	Silver	I-99-0089
PK-4/110	Polanik	Competition, Turned steel, dia: 110mm	Various	I-12-0581

Personal Implements will also be allowed, providing that:

- they are readily identifiable and are World Athletics certified;
- they are not already on the official list;
- they have been checked for compliance with World Athletics Rules;
- they are made available to all the other athletes.

If you do not find your implement in the list but you believe that it is/was certified, please contact the WA office at technicalofficer@worldathletics.org so that its status can be checked and confirmed to you and the LOC in due time.

Location and Time for submitting	Return
At the TIC by 18.00, the day before competition. A receipt will be given for the implements.	Implements will be returned in exchange for the receipt after the event at the TIC.

8 ENTRIES AND FINAL CONFIRMATIONS

8.1 Entry Rules

- **Individual Events** (except CE – see later)
 - Each Member will be allowed to participate with a maximum of two qualified athletes (three in case of a Wild Card) in each event, subject to the below.
 - A third (fourth in case of a Wild Card) qualified athlete can be entered as a reserve.
- **Combined Events**
 - 12 athletes will be invited in the **Heptathlon** and in the **Pentathlon** as follows:
 - the winner of the 2021 Combined Events Challenge
 - the five best athletes from the 2021 Outdoor Lists (as at 31 December 2021), limited to a maximum of one per country
 - the five best athletes from the 2022 Indoor Lists (as at 1 March 2022)
 - one athlete which may be invited at the discretion of World Athletics
 - In total no more than two male and two female athletes from any one Member will be invited. Upon refusals or cancellations, the invitations will be extended to the next ranked athletes in the same lists respecting the above conditions.
- **Relays**
 - There is no entry standard and each Member Federation will be able to enter one team of up to eight athletes in each event.
- **World Indoor Tour:**
 - The individual overall winner of each event of the World Indoor Tour 2021 and 2022 will automatically qualify for the World Athletics Indoor Championships by Wild Card.
 - The Member Federation of the World Indoor Tour winner will have the ultimate authority to enter the athlete or not, based on its own criteria or qualification system.
 - If a Member Federation has three athletes qualified as a result, all three will be permitted to compete.
- **Unqualified Athletes**
 - Members who have **no male and/or no female qualified athletes** (eligible by Entry Standard) in any event may enter one unqualified male athlete OR one unqualified female athlete in a running event (except the 800m).
 - In exceptional cases, and as agreed by the Technical Delegates, entry of unqualified athletes in the 800m, Long Jump, Triple Jump or Shot Put may be accepted. Applications for such entries must be submitted to World Athletics (teamservices@worldathletics.org) by no later than **1 March 2022**.
 - If the **host country** does not have a qualified athlete in an event, it may enter one athlete in this event regardless of any Entry Standard (except for the Combined Events). For the Field Events and 800m, the entry is at the discretion of the Technical Delegates and must be submitted to World Athletics (teamservices@worldathletics.org) by no later than **1 March 2022**.
- **Target number of athletes/teams by event**
The target number of athletes/teams by event will be as follows:

Events	Target Number
60m	56
400m	30
800m	18

1500m	18
3000m (Men's)	24
3000m (Women's) – straight final	15
60m hurdles	48
High Jump, Pole Vault	12
Long Jump, Triple Jump, Shot Put	16
Combined Events	12
Relays	n/a

8.2 Age Categories

- U20 Athletes: any athlete aged 18 or 19 years on 31 December 2022 (born in 2004 or 2003) may compete in any event.
- U18 athletes: any athlete aged 16 or 17 years on 31 December 2022 (born in 2006 or 2005) may compete in any event except the Shot Put
- Athletes younger than 16 years on 31 December 2022 (born in 2007 or later) may not compete in any event.

8.3 Entry Standards

The Entry Standards were approved by the Council in March 2021 and are as follows:

WOMEN			MEN	
Indoor	Outdoor	Event	Indoor	Outdoor
7.30	11.15 (100m)	60m	6.63	10.10 (100m)
52.90	51.00	400m	46.50	45.00
2:01.50	1:58.00	800m	1:46.70	1:44.00
4:09.00 / 4:28.50 (Mile)	4:02.00	1500m	3:39.00 3:55.00 (Mile)	3:33.00
8:49.00	8:30.00 / 14:50.00 (5000)	3000m	7:50.00	7:40.00 / 13:10.00 (5000m)
8.16	12.85 (100mH)	60m H	7.72	13.40 (110mH)
No Standard		4x400 R	No Standard	
1.97		HJ	2.34	
4.75		PV	5.81	
6.80		LJ	8.22	
14.30		TJ	17.10	
18.30		SP	21.10	

CONDITIONS FOR THE VALIDITY OF PERFORMANCES:

- Performances must be achieved during the qualification period of 1 January 2021 to 7 March 2022, except for the Combined Events
- Performances must be achieved during **competitions organised or authorised by World Athletics**, its Area Associations or its National Member Federations. Thus, results achieved at university or school competitions must be certified by the National Federation of the country in which the competition was organised.

- Performances must be achieved during an official competition organised in **conformity with World Athletics Rules**.
- Performances achieved in **mixed competitions in track events** will not be accepted. Exceptionally, in accordance with Rule 9 of the Technical Rules, performances achieved in the 5000m event may be accepted in circumstances where there were insufficient athletes of one or both genders competing to justify the conduct of separate races and there was no pacing or assistance given by an athlete(s) of one gender to an athlete(s) of the other gender under specific circumstances and conditions (see TR9).
- **Wind-assisted performances** will not be accepted.
- **Hand-timed performances** in 60m, 100m, 400m, 800m, 60m Hurdles, and 100m/110m Hurdles will not be accepted.
- For the running events of 400m and over, performances achieved on **oversized tracks** will NOT be accepted.

Consultation processes included Technical Delegates and Statisticians.

8.4 Final Entries

The deadline for completing and submitting entries via the World Athletics online Event Entry System is Monday 7 March 2022. (Midnight Monaco Time).

No changes or additions will be accepted after the closing date.

Technical Delegates may request member federations to submit a copy of the official results of the event where the qualifying performances have been achieved.

8.5 Final Confirmations

8.5 Final Confirmations

8.5.1 General

A Final Confirmation online tool will be used. Teams will receive suitable instructions to log in to their reserved area with a username and password. Team Leaders, or their representatives, must confirm the names of those athletes already entered, who will actually take part in the competition.

Final confirmation for all events must be made online, at the latest, by 12.00 on Thursday 17 March. An Info Desk to support with On Line Confirmation procedure will be arranged at the Teams Accreditation Centre, in the WA/LOC Administrative Office at the Crowne Plaza Hotel. In case of late arrivals on 17 March, Member Federations must confirm the athletes for all days of competition by email to statistics@worldathletics.org.

8.5.2 Relays

The final composition of the relay teams and the order of running must be declared at the TIC no later than one hour before the scheduled entry to the call room (i.e. the reporting point in the warm-up area). Detailed times indicated below:

DAY 3 – Sunday, 20-Mar					
Event	Gender	Phase	Start Time	At reporting point	Deadline to declare running order at TIC
4 x 400m Relay	W	R1	11:10	10:40	09:40
4 x 400m Relay	M	R1	11:35	11:05	10:05
4 x 400m Relay	W	F	19:40	19:10	18:10
4 x 400m Relay	M	F	19:55	19:25	18:25

In case the timetable changes, the deadline to declare the composition of the Team will be modified accordingly and it will always be no later than one hour before the scheduled entry to the call room (i.e. the reporting point in the warm-up area).

Any four athletes among those entered for the competition, whether for the relay or for any other event, may then be used in the composition of the team for the first round.

Substitutes may only be taken from the list of entered athletes, whether for the relay or for any other event.

9. COMPETITION PROCEDURES

9.1 Orientation Visit for Team Leaders and Coaches

A visit to the competition venue and warm-up area will take place on Thursday 17 March at 09:15, in order for the Team Leaders and coaches to familiarise themselves with the exact location of the various facilities (warm-up area, call room, team seating etc.). Meeting point at Team tents.

9.2 Technical Delegates Availability

There will not be an official Technical Meeting however the Technical Delegates, together with staff from the LOC and World Athletics Competition Department, will be available after the orientation visit for any questions or clarification that may be required.

9.3 Timetable

The timetable for Belgrade was approved by the Council in March 2021 can be found at the end of the Team Manual.

Information on any changes to the official timetable will be provided through the TIC.

9.4 Athletes' Bibs

The bibs will be distributed during the administrative procedure at the WA / LOC office in the Crowne Plaza Hotel. Bibs which are not collected, will be taken to the Stadium TIC on Thursday afternoon.

All athletes will receive three bibs as follows:

- One bib with the name for the front of the competition vest
- One bib with the number for the back of the competition vest
- One bib with the name to be used for the tracksuit or the bag

Every athlete must wear two bibs during the competition, except in all jumping events, that athletes can decide to wear only one bib on the front or on the back (bib with the name).

The bibs with the name for the track events will be distributed in the call room. Those bibs will include transponders.

The bibs for the relays (carrying the country code – (e.g. SRB) will be handed out at the call room and placed on the back.

Special bibs (green background) shall be used for the leader of the combined events after each event. These shall be handled directly by the Combined Events Referee and distributed at the combined events rest area.

Bibs must be worn in accordance with World Athletics Rules and must not be cut, folded or obscured in any way. Failure to comply with the Rules may result in a disqualification or sanction.

9.5 Team Kit

All athletes must compete in the uniform clothing approved by their Member Federation and all members of the same team in each event must wear the official uniform. All national team kit (i.e. whether Member Federations have a national sponsor on their national team kit or not) must be submitted via the online form. Please [complete the online kit approvals form](#) and remember to upload images of the kit when completing the form. The deadline to submit team uniforms for approval, including any proposed sponsors of Member Federations to appear on team uniform (in order to avoid conflicts), is Monday 14 February 2022. If you plan to have the same kit throughout 2022 then you can complete the relevant option in the online form. If you have already indicated this then there is no action required by you.

Further information about the process and the form to complete for submission to World Athletics has been circulated separately in Circular M/46/21 published on 03 December 2021.

Please also note:

- i. that any logos placed on facemasks must comply with the size requirements for accessories as stated in the regulations and guidelines;
- ii. kit is approved (including any accessories) on the condition and expectation that athletes will wear the approved kit (including any accessories) issued by the Member Federations to their teams. Please remind athletes if they wear any other kit (including accessories) (e.g. personal kit) then all logos (including the brand) on that kit may either be taped over or the athlete, at any time, may be instructed by any official (not just the call room officials) to remove the accessory or asked to take other action so that the logo(s) on that kit is (are) not visible;
- iii. in accordance with World Athletics Competition and Technical Rules (TR5.1), the Victory Ceremony is considered part of the competition for this purpose. Presentation bibs will be provided to the medal winners and must be worn and be clearly visible during the awards ceremony.

The Marketing and Advertising Regulations can be found by [clicking here](#) – See Book C: C7.1. A set of visual guidelines that support the regulations can be found by [clicking here](#) – See WAS Events: Guidelines on Clothing and Accessories.

For WIC Belgrade22, the Official Partners are the following:

- Official Partners: ASICS, QNB, SEIKO, TDK
- WA Media Partner: TBS, EBU/ESPN
- Official Suppliers: Mondo, Nielsen, Pinsent Masons

The National Partners and Suppliers will be announced at a later stage.

Questions concerning the approval process can be emailed to: kitapprovals@worldathletics.org

Any infringement of the Rules may result in the disqualification of the athlete. Athletes not wearing their official team uniform will be required to acquire the correct attire before they progress through the Call Room.

9.6 Personal Belongings

Athletes will not be permitted to take any backpack, or similar sized bag, or any prohibited items, including tape measure, with them into the competition arena.

Combined Events athletes may bring large bags, but they must be left in the rest area in between events. Athletes are requested not to take with them to the competitions area bulky items or other inappropriate items.

A strict inspection will be made on illegal and prohibited items, which athletes may have in their possession. Smart watches, radios, CD/MP3 players, mobile phones, cameras, etc. shall not be permitted. Any items that do not conform to the WA technical and/or advertising Rules and Regulations will be confiscated. Confiscated items may be retrieved at the Post Event Area after the event.

9.7 Call Room Procedures

The Call Room shall be located between the warm-up area and the main stadium. All athletes must present themselves to the reporting point at the warm up area according to the scheduled times as noted below. Times will also be announced over the PA system as well as shown on the electronic display in the warm-up area.

Athletes who fail to appear on time at the reporting point without a valid reason may be excluded from participating in this and all further events in the Championships, including relays. Team officials are not allowed to enter the call room.

Call Room Reporting Times – all times are prior to the actual starting time of the event:

Event	Report to Reporting point	Arrival at Field of Play
Track Events and Relays	30 mins	5 mins
High Jump	60 mins	40 mins
Pole Vault	80 mins	60 mins
Long/Triple Jump	55 mins	30 mins
Shot Put	55 mins	30 mins

Note: Times may change slightly depending on the number of entries and changes will be displayed at TIC and CID.

A dedicated, heat by heat, call-up schedule will be issued once final entries are confirmed.

This will be displayed at the warm-up area and Team Hotels.

The procedures in the call room shall be as follows:

- Identification of athletes by means of their accreditation card and bib.
- Checking of athletes' uniform
- Inspection of personal belongings
- Checking of shoe spikes (number, shape and size). The maximum size allowed for all events is 9mm

If they do not comply with WA Rules, the athletes will be asked to change them to the correct size.

After completion of these procedures, athletes must follow the instructions given by the officials at the call room before being escorted onto the Field of Play.

Athletes who compete in combined events shall report to the reporting point only for the first event of each day. For the first event of the day, the above reporting times apply. As time allows, between events they will be escorted back to the combined events rest areas, from where the Combined Events Referee will manage movement to subsequent events. Pre-competition checks will take place in the Combined Events Rest Room Areas before the start of each event.

Team Leaders must ensure that all their athletes comply with the above before entering the call room to avoid delays.

Athletes must report to the Call Room wearing their FFP-2 mask and will be authorized to remove it only when entering the field of play. Dedicated personnel from the LOC (equipped with masks and gloves) will collect masks left by Athlete and treat this material as a potential contaminated waste. Athletes will be handed new masks at the Post Event Area.

9.8 Track Events

Athletes competing in track events will be required to change into their competition uniform and spiked shoes in the call room. Their personal belongings will be taken directly from here to the post event area.

The starter's commands will be given in English.

Hip numbers will be provided in the call room.

9.9 Field Events

9.9.1 High jump and pole vault

High Jump and pole vault events shall be normally conducted as straight Finals.

9.9.2 Horizontal Field Events

The long jump, triple jump and shot put will be held as straight finals with sixteen athletes starting in each event.

- All athletes have three initial trials
- The top eight athletes after three rounds of trials have two additional trials

9.10. Coaching Zones

Field Event Coaches will be given access to dedicated coaching zones in the tribunes by special Coaches Seating Passes which will be distributed through the TIC (one per athlete). The coaches concerned must gather at the TIC according to the same Call Room reporting times as their athletes (see table in Call Room Procedures) from where they will be escorted to the reserved seats.

9.11 Timing and Measurement

Official timing and measurement will be provided by SEIKO. Video Distance Measurement (VDM) will be used as the official measurement system to determine the results in the horizontal jumps. All trials of all athletes are recorded and stored in the system.

9.12 Post Competition Procedures

All athletes will depart from the competition area via the mixed zone. In the mixed zone, the media may conduct short interviews.

After passing through the mixed zone, athletes move on to the post event area where they will be able to recover and collect their clothing. The Medallists of each event will then proceed to the Medallists Press Conference room for the formal media conference.

Athletes will be notified of requirements for doping control tests after the mixed zone.

9.13 Medal Ceremonies

Medallist will receive their medals inside Stark Arena.

The first, second and third placed athletes in each individual event and the first three teams in each relay race will be presented with a gold, silver and bronze medal respectively.

If a team competes in the relay final with different athletes to the first round, only the four athletes in the final will be awarded medals during the official ceremony. The other athletes will be able to collect their medals later from the Technical Information Centre (TIC).

Where medal ceremonies are held during the same session as the respective competition, the ceremony will usually take place before doping control procedures and possibly before the athletes have completed media commitments.

LOC staff will gather the placed athletes or relay teams and escort them to the Medal Ceremonies Preparation Room, via kit collection, where they will be briefed and wait for the ceremony.

For medal ceremonies taking place during the following session or day, medallists will receive an information sheet in post event control which will indicate the time and location they need to report to the following day, from which they will be escorted to the Medal Ceremonies Preparation Room.

Athletes must wear their delegation's official uniform for medal ceremonies. For medal ceremonies taking place during the same session, where possible, official uniform should be brought in the athlete's bag. If an athlete that wins a medal does not have their official uniform in their bag for the ceremony, team officials should take the athletes official uniform directly to the TIC contact desk.

During the playing of the anthem and the raising of the flags, medallist shall face the flags and conduct themselves in a dignified manner at all times.

Medallists will not be permitted to bring a national flag nor any other items to the ceremony.

After medal ceremonies have taken place, medallists will be escorted back to the Medal Ceremonies Preparation Room.

Where the medal ceremony has taken place during the same session as their event, athletes will then be escorted back to the point of the mixed zone or post event control where they were first escorted from.

Where the medal ceremonies have taken place during the following session or day, athletes will be escorted back to the initial reporting location.

9.14 Protests and Appeals

Protests and Appeals will be handled according to Rule 8 of the Technical Rules. Protests and appeals will be handled by the TIC at the Arena.

9.14.1 Protests

Protests concerning the result or conduct of an event shall be made within 30 minutes of the official announcement of the result of that event. The Organising Committee of the competition shall be responsible for ensuring that the time of the announcement of all results is recorded.

Any protest shall be made verbally to the referee, by an athlete, by someone acting on his behalf or by an official representative of a team. Such person or team may protest only if they are competing in the same round of the event to which the protest (or subsequent appeal) relates. To arrive at a fair decision, the referee should consider any available evidence which he thinks necessary, including a film or picture produced by an official video recorder, or any other available video evidence. The referee may decide on the protest or may refer the matter to the jury.

If the referee makes a decision, there shall be a right of appeal to the jury. Where the referee is not accessible or available, the protest should be made to him through the Technical Information Centre.

9.14.2 Appeals

An appeal to the Jury of Appeal must be made within 30 minutes:

- a) of the official announcement of the amended result of an event arising from the decision made by the referee; or
- b) of the advice being given to those making the protest, where there is no amendment of any result.

It shall be in writing, signed by a responsible official on behalf of the athlete or team, and shall be accompanied by a deposit of USD 100, or its equivalent, which will be forfeited if the appeal is not allowed.

Note: The relevant referee shall, after his decision on a protest, immediately inform the TIC of the time of the decision. If the referee was unable to communicate this verbally to the relevant team(s) /athlete(s), the official time of the announcement will be that of the posting of the amended results or of the decision at the TIC.

9.15 Competition Awards

9.15.1 Prize Money

During the World Athletics Indoor Championships, the top six athletes or teams in each event will be awarded the following prizes by World Athletics:

Position	Individual	Position	Relay teams
1 st	USD 40,000	1 st	USD 40,000
2 nd	USD 20,000	2 nd	USD 20,000

3 rd	USD 10,000	3 rd	USD 10,000
4 th	USD 8,000	4 th	USD 8,000
5 th	USD 6,000	5 th	USD 6,000
6 th	USD 4,000	6 th	USD 4,000

Payments will be made following confirmation of doping control tests and submission of complete Award Forms with full bank details. The LOC has confirmed that there will be no taxes to be paid on prize money.

The Award Form for Individual Events can be found in Appendix. It must be returned to awards@worldathletics.org but it will also be possible to return it to the Stadium TIC. The Relay awards will be managed directly with the Member Federations concerned.

9.15.2 World Record Bonus

World Record Bonus

In the event that an athlete breaks a World Record during the World Athletics Indoor Championships, a prize of USD 50,000 will be awarded. The World Record Bonus will only be awarded for performances which improve the existing World Record, and which meet all the necessary rules, conditions and procedure for recognition as a World Athletics Record as set out in World Athletics' Competition Rules, and after the record has been ratified by World Athletics. A copy of the World Athletics' Competition Rules along with the World Record Application Forms are available at [this link](#).

Rights and Obligations in Relation to the Prize Money and World Record Bonus

Athletes confirm that they will make themselves available to World Athletics for promotional activities as set out in the athlete agreement.

If an athlete's Doping Control results return positive, the awards and bonuses won will be withheld.

10. MEDICAL SERVICES (please see Covid Medical protocol too)

Overview

A specific medical guide is being prepared, for team medical staff, which will contain all relevant information on the medical services at the competition venues and official accommodation. The medical guide will be distributed at the technical meeting or can be collected from the team hotels.

Key Phone Numbers

The National Medical emergency phone number is: 194

LOC Medical Director: Dr Nikola Ćliriz +381641587525

Covid manager: Dr Sinisa Masić +381638026327

Designated Medical Institutions

The event designated hospitals are Medical Military academy and for Covid patient Medical hospital Karaburma and KBC Bezanijaska kosa.

Medical Service

To request any medical care from the LOC during operational hours, team members who suffer from injury or illness should present themselves at the nearest medical point. Outside operating hours, team members should use the emergency contact number for the persons in hotels.

Persons who seek medical care must show valid identity documents, such as an ID card or passport and accreditation card.

Warm Up Medical Services

During the official opening hours of the warm-up area, the medical services available:

- Emergency services (one ambulance with medical doctor and nurse)
- Physiotherapy
- Sport massage

Stark Arena

During competition and training times (17th March to 20th March), the following services will be available from one hour before the opening of the venue, until 30 minutes after the end of the competition:

- Emergency services (one ambulance with medical doctor and nurse)
- Additional 2 doctors and 2 nurses during the stadium opening hours
- Medical room is available during opening hours from 09:00-20:00 from 17th March to 20th March. Out of opening times, a doctor will be always available in the hotel Crown plaza but on call.
- Opening hours for the physiotherapy services will be 09:00-18:00 from 16th March to 20th March.

Athletes have priority to all services and exclusive access to physiotherapy and sport massage. Other categories (Team Officials, Technical Officials, Workforce) will have access to emergency medical services only.

FOP Medical Teams

Half an hour before the start of the competition until the end of the competition, 2 medical teams will be located on each bends' start and finish segments.

Medical Services in Team Hotels

- Crown plaza hotel – medical doctor
- Other hotels on call

Physiotherapy rooms will be available for teams 24 hours from 16th to 20th March.

Medical Insurance

All World Athletics member federations are responsible for subscribing to an insurance policy that covers injuries and/or illness and treatment of Covid infections to any member of their delegation and/or team travelling to and from World Athletics competitions and during the event itself.

Medical Delegate and Procedures during Competition

The World Athletics Medical Delegate, Dr. Paolo Emilio Adami, or his appointed representative, is the only responsible for all kind of special clarification, notification of change for a relay, removal of an athlete from a competition, or designated exceptional permission for team doctors and physiotherapists to enter into restricted areas.

During competition, in case of an athlete's injury or illness, a certificate must be requested from the official medical service and presented to the TIC, in regard to withdrawal from the event. These certificates will be attested by the World Athletics medical delegate or his appointed representative in his absence.

Other Medical Matters

Team Doctor's practice

During the tournament, Team doctors can diagnose and treat athletes of their own team only. It is forbidden to provide treatment for Serbian nations (except in case of emergency)

All prescriptions from team doctors must be arranged through the LOC medical team.

Importation of medicines

The team doctors can import drugs and medical supplies to Serbia for personal use or team use, on the principle of "reasonable amount for personal or team use".

The head doctor accompanying a team must provide a list of the medicines the team is bringing into Serbia, including dosages and quantities.

Opium, heroin, cannabis, and other narcotics and psychotropic drugs that are addictive are prohibited to enter in Serbia.

Unused drugs and medical supplies shall be re-shipped out of Serbia within one month after the end of the sports event.

Distribution of Ice

Ice will be provided at the competition and training venues and the official Team Hotels.

11. COVID19 Information (see full Covid-19 Protocol)

The full Medical Clearance protocol is published on

<https://www.worldathletics.org/competitions/world-athletics-indoor-championships/belgrade22> (scroll down the webpage to the General section)

11 DOPING CONTROL

Sample collection at the World Athletics Indoor Championships in Belgrade 2022 will be conducted in accordance with World Athletics Anti-Doping Rules. The programme will be overseen by the World Athletics Anti-Doping Delegate, with the LOC responsible for organising the testing.

The sample collection programme will consist of both pre and in competition testing, carried out from the official opening of the team hotels until the end of the Championships.

Athletes will be selected for testing through a combination of random and intelligence-led methods and will be notified of their selection by trained and accredited Officers. A Team leader or official may be required to help in notifying the athlete who may be accompanied by a representative to the sample collection station.

At the time of notification, the sample collection officer will present their accreditation and advise which sample is required. They will then chaperone the athlete to the sample collection station where the sample will be collected. Official identification will be required before providing the sample, so athletes must ensure that they carry identification documents at all times (passport, ID card). A specific Covid-19 protocol will be applied during the sample collection process.

An athlete breaking or equalling a World Record (including a World U20 Record) will be required to undergo doping control for ratification purposes. Should an athlete request sample collection for the ratification of an Area or a National Record etc., such a test will be carried out for a fee at the request of a team official. A request for the record test will need to be completed at the Technical Information Centre (TIC) before the sample can be collected.

A significant increase of requests for additional doping controls for the validation of National Records has been observed at World Athletics Series events and every effort will be made to accommodate these extra doping controls, which come on top of the doping controls planned for the event. However, priority will be given to the doping controls planned for the event.

We are asking the athletes whose national rules allow for delayed testing (e.g 48h or 72h) to arrange for doping controls with their local anti-doping agency after the event.

Please note that World Athletics cannot guarantee that it will be able to accommodate all requests.

Athletes, who therapeutically use substances or methods included on the prohibited list, must ensure they have the appropriate authorisation in place before the Event, in accordance with the World Athletics Anti-Doping Rules.

For further information regarding the rules, please go to:

<https://www.athleticsintegrity.org/know-the-rules>

12. MOWA INDOOR ATHLETICS HERITAGE EXHIBITION BELGRADE22

WHAT

Indoor Athletics Collection

- **Display of competition artefacts** (clothing, shoes, trophies and medals) donated to the WA Heritage Collection by **25 world indoor champions & record breakers**, with supporting video, photographic, and text content.
- **Virtual Reality Headsets** to take you on a tour of the **Museum of World Athletics (MOWA)** - <https://worldathletics.org/heritage>

WHERE

The Stark Arena, Belgrade

(Level One, directly above the main spectator entrance)

WHEN

Official Opening Ceremony - 5 March 2022

Open on the following days:

Saturday 5 to Monday 7 March (ticket holders & accredited)

Wednesday 16 to Thursday 17 March (accredited only)

Friday 18 to Sunday 20 March (ticket holders & accredited)

WHO

- World Athletics Heritage Guest **Blanka Vlasic**
Two-time world outdoor and indoor high jump champion.
- WA President **Sebastian Coe** will visit the exhibition on the morning of Friday 18 March (1100hrs CET tbc) along with Blanka Vlasic and other guests.

13 OFFICIAL MERCHANDISE

The World Indoor Championships Official Merchandise booth will be located at the Main Public North Entrance of the Stark Arena.

You can also find the selection on www.shop.worldathletics.org

WORLD ATHLETICS INDOOR CHAMPIONSHIPS – BELGRADE 2022

TIMETABLE

DAY 1 - Friday, Morning, 18 March				DAY 2 - Saturday, Morning, 19 March				DAY 3 - Sunday, Morning, 20 March			
09:35	60m H Pen	W	Heats	09:30	60m H Hep	M	Heats	10:05	60m H	M	R1
09:55	60m Hep	M	Heats	09:50	60m H	W	R1	10:45	High Jump	M	F
10:15	60m	W	R1	10:30	Pole Vault Hep	M		11:00	Triple Jump	W	F
10:40	Long Jump Hep	M		10:45	60m	M	R1	11:10	4 x 400m Relay	W	R1
11:00	400m	M	R1	11:00	High Jump	W	F	11:35	4 x 400m Relay	M	R1
11:10	High Jump Pen	W		11:40	800m	W	R1	11:52	Pole Vault	W	MC
11:45	400m	W	R1	12:05	3000m	W	MC	12:05	3000m	M	F
12:05	Shot Put Hep	M		12:15	1500m	M	R1	12:45	60m H	W	MC
12:10	Triple Jump	M	F	12:55	Shot Put	W	MC	12:51	60m	M	MC
12:30	1500m	W	R1	13:00	Long Jump	M	MC				
13:00	800m	M	R1								
13:20	Shot Put Pen	W									
13:30	3000m	M	R1								
DAY 1 - Friday, Afternoon, 18 March				DAY 2 - Saturday, Afternoon, 19 March				DAY 3 - Sunday, Afternoon, 20 March			
	Opening Ceremony			17:45	60m	W	MC	16:35	High Jump	M	MC
17:35	Triple Jump	M	MC	17:53	High Jump	W	MC	16:41	Triple Jump	W	MC
17:45	Long Jump Pen	W		18:05	Pole Vault	W	F	16:47	3000m	M	MC
18:10	60m	W	SF	18:15	60m H	W	SF	16:53	Shot Put	M	MC
18:35	400m	W	SF	18:40	60m	M	SF	17:05	60m H	M	SF
18:55	Shot Put	W	F	19:10	800m	M	F	17:17	Pole Vault	M	F
19:00	High Jump Hep	M		19:30	1000m Hep	M	F	17:30	Long Jump	W	F
19:05	Long Jump	M	F	19:40	Shot Put	M	F	18:05	800m	W	F
19:10	400m	M	SF	19:50	400m	W	F	18:35	1500m	M	F
20:00	800m Pen	W	F	20:10	400m	M	F	18:42	800m	W	MC
20:30	3000m	W	F	20:25	800m	M	MC	19:30	60m H	M	F
20:55	60m	W	F	20:35	1500m	W	F	19:40	4 x 400m Relay	W	F
21:00	Pentathlon	W	MC	21:05	60m H	W	F	19:45	1500m	M	MC
				21:10	Heptathlon	M	MC	19:55	4 x 400m Relay	M	F
				21:20	60m	M	F	20:00	Long Jump	W	MC
				21:25	400m	W	MC	20:06	Pole Vault	M	MC
				21:31	400m	M	MC	20:12	60m H	M	MC
				21:37	1500m	W	MC	20:18	4 x 400m Relay	W	MC
								20:25	4 x 400m Relay	M	MC

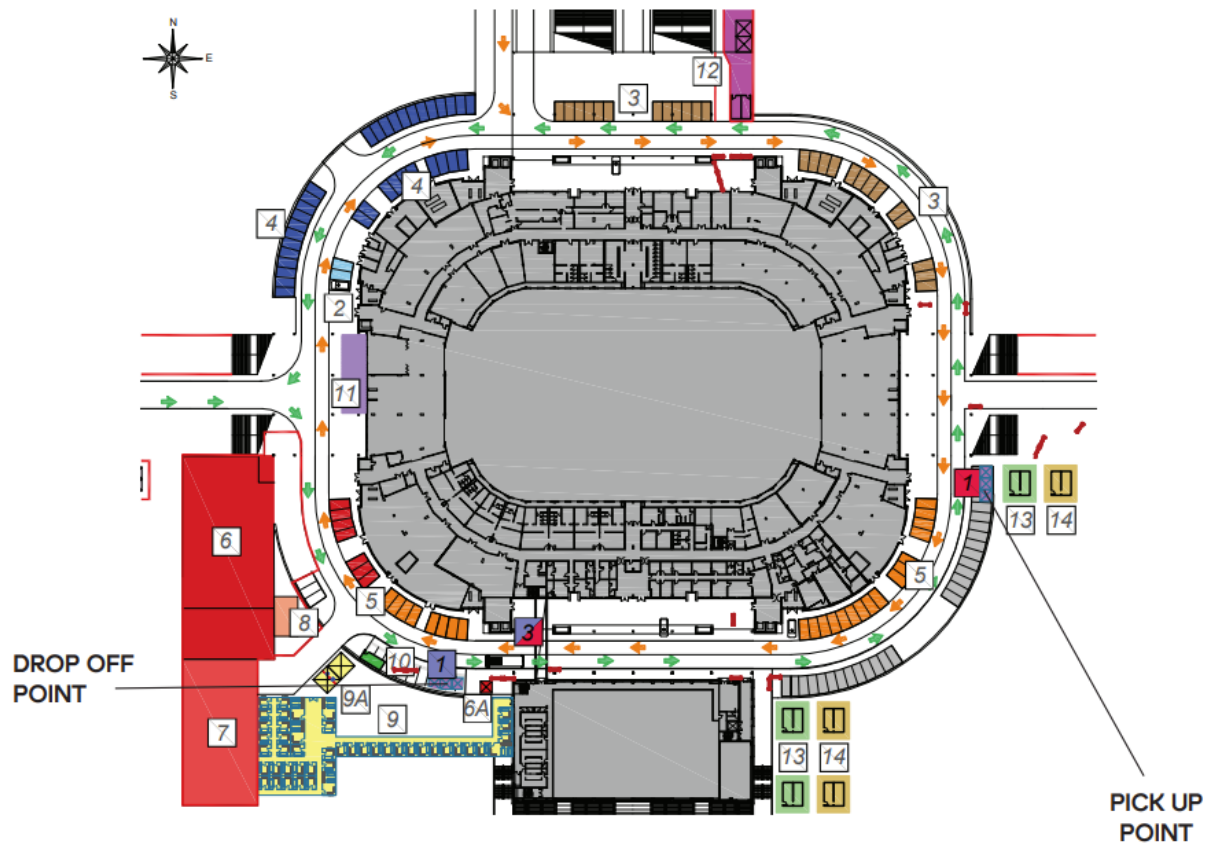

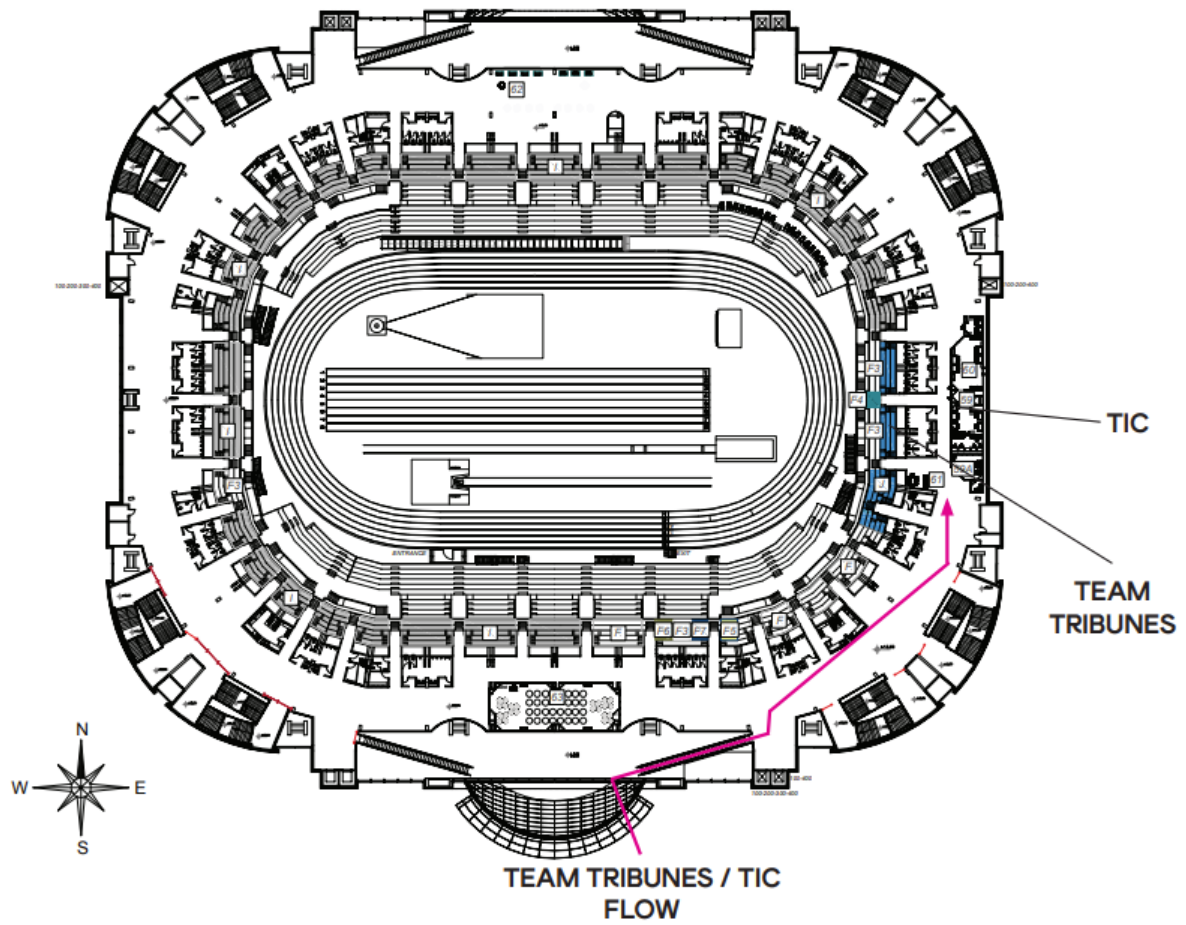

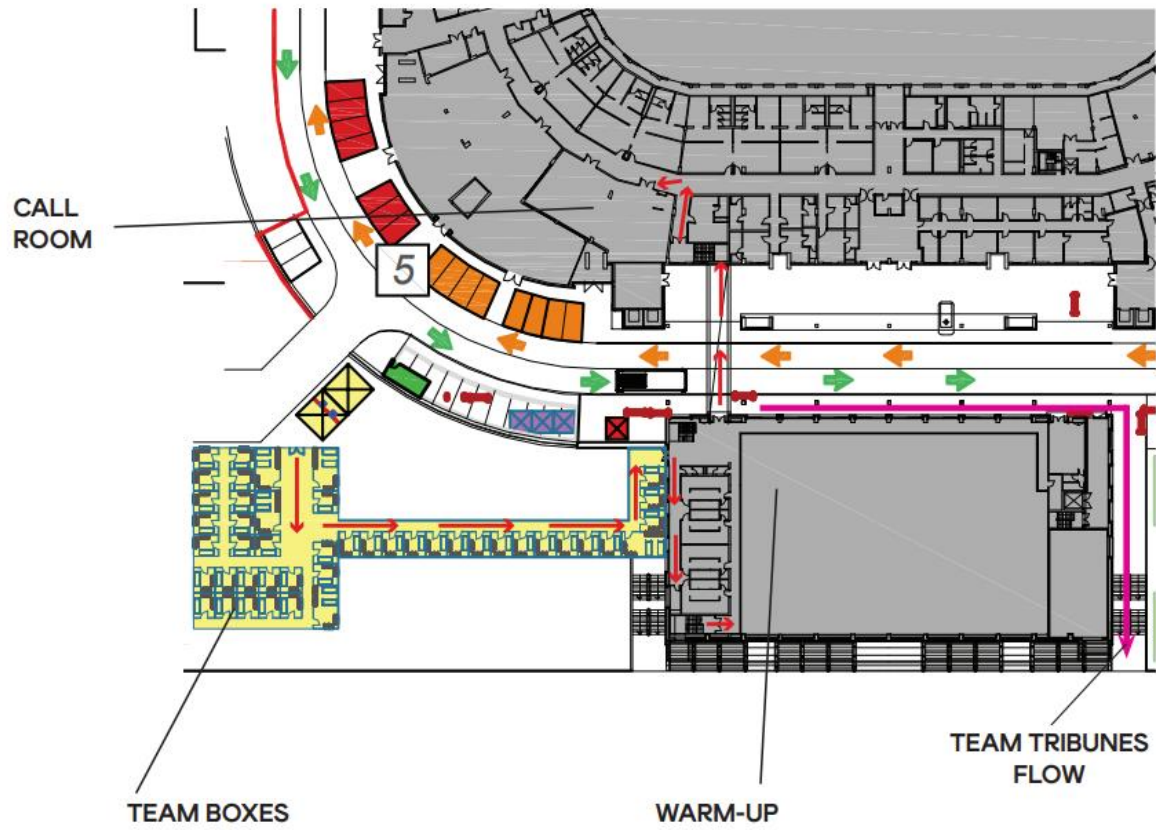

WORLD ATHLETICS INDOOR CHAMPIONSHIPS – BELGRADE 2022
VISA INFORMATION BY MEMBER FEDERATION

Federation	Code	Area	No visa	Needs visa & SRB Embassy	Needs visa & NO SRB Embassy
AFGHANISTAN	AFG	ASI			X
ALBANIA	ALB	EUR	X		
ALGERIA	ALG	AFR		X	
AMERICAN SAMOA	ASA	OCE			X
ANDORRA	AND	EUR	X		
ANGOLA	ANG	AFR		X	
ANGUILLA	AIA	NAM	X		
ANTIGUA & BARBUDA	ANT	NAM	X		
ARGENTINA	ARG	SAM	X		
ARMENIA	ARM	EUR	X		
ARUBA	ARU	NAM			X
AUSTRALIA	AUS	OCE	X		
AUSTRIA	AUT	EUR	X		
AZERBAIJAN	AZE	EUR	X		
BAHAMAS	BAH	NAM	X		
BAHRAIN	BRN	ASI	X		
BANGLADESH	BAN	ASI			X
BARBADOS	BAR	NAM	X		
BELARUS	BLR	EUR	X		
BELGIUM	BEL	EUR	X		
BELIZE	BIZ	NAM			X
BENIN	BEN	AFR			X
BERMUDA	BER	NAM	X		
BHUTAN	BHU	ASI			X
BOLIVIA	BOL	SAM	X		
BOSNIA-HERZEGOVINA	BIH	EUR	X		
BOTSWANA	BOT	AFR	X		
BRAZIL	BRA	SAM	X		
BRITISH VIRGIN ISLANDS	IVB	NAM	X		
BRUNEI	BRU	ASI			X
BULGARIA	BUL	EUR	X		
BURKINA FASO	BUR	AFR			X
BURUNDI	BDI	AFR	X		
CABO VERDE	CPV	AFR			X
CAMBODIA	CAM	ASI			X
CAMEROON	CMR	AFR			X
CANADA	CAN	NAM	X		

CAYMAN ISLANDS	CAY	NAM	X		
CENTRAL AFRICAN REPUBLIC	CAF	AFR			X
CHAD	CHA	AFR			X
CHILE	CHI	SAM	X		
CHINESE TAIPEI	TPE	ASI		X	
COLOMBIA	COL	SAM	X		
Commonwealth of DOMINICA	DMA	NAM	X		
COMOROS	COM	AFR			X
CONGO	CGO	AFR			X
COOK ISLANDS	COK	OCE	X		
COSTA RICA	CRC	NAM	X		
CROATIA	CRO	EUR	X		
CUBA	CUB	NAM	X		
CYPRUS	CYP	EUR	X		
CZECH REPUBLIC	CZE	EUR	X		
DEM. REP. OF SAO TOME E PRINCIPE	STP	AFR			X
DEMOC. REPUBLIC OF CONGO	COD	AFR			X
DENMARK	DEN	EUR	X		
DJIBOUTI	DJI	AFR			X
DOMINICAN REPUBLIC	DOM	NAM			X
DPR OF KOREA	PRK	ASI			X
ECUADOR	ECU	SAM			X
EGYPT	EGY	AFR		X	
EL SALVADOR	ESA	NAM			X
EQUATORIAL GUINEA	GEQ	AFR			X
ERITREA	ERI	AFR			X
ESTONIA	EST	EUR	X		
ESWATINI	SWZ	AFR			X
ETHIOPIA	ETH	AFR		X	
FIJI	FIJ	OCE			X
FINLAND	FIN	EUR	X		
FRANCE	FRA	EUR	X		
FRENCH POLYNESIA	PYF	OCE	X		
GABON	GAB	AFR			X
GEORGIA	GEO	EUR	X		
GERMANY	GER	EUR	X		
GHANA	GHA	AFR			X
GIBRALTAR	GIB	EUR	X		
GREAT BRITAIN & N.I.	GBR	EUR	X		
GREECE	GRE	EUR	X		
GRENADA	GRN	NAM	X		

GUAM	GUM	OCE	X		
GUATEMALA	GUA	NAM			X
GUINEA	GUI	AFR			X
GUINEA-BISSAU	GBS	AFR	X		
GUYANA	GUY	SAM			X
HAITI	HAI	NAM			X
HONDURAS	HON	NAM			X
HONG KONG, CHINA	HKG	ASI	X		
HUNGARY	HUN	EUR	X		
ICELAND	ISL	EUR	X		
INDIA	IND	ASI	X		
INDONESIA	INA	ASI	X		
IRAQ	IRQ	ASI		X	
IRELAND	IRL	EUR	X		
ISLAMIC REPUBLIC OF IRAN	IRI	ASI		X	
ISRAEL	ISR	EUR	X		
ITALY	ITA	EUR	X		
IVORY COAST	CIV	AFR			X
JAMAICA	JAM	NAM	X		
JAPAN	JPN	ASI	X		
JORDAN	JOR	ASI			X
KAZAKHSTAN	KAZ	ASI	X		
KENYA	KEN	AFR		X	
KIRGHIZSTAN	KGZ	ASI	X		
KIRIBATI Rep of	KIR	OCE			X
KOREA	KOR	ASI	X		
KOSOVO	KOS	EUR	X		
KUWAIT	KUW	ASI	X		
LAOS	LAO	ASI			X
LATVIA	LAT	EUR	X		
LEBANON	LBN	ASI		X	
LESOTHO	LES	AFR			X
LIBERIA	LBR	AFR			X
LIBYA	LBA	AFR		X	
LIECHTENSTEIN	LIE	EUR	X		
LITHUANIA	LTU	EUR	X		
LUXEMBOURG	LUX	EUR	X		
MACAO	MAC	ASI	X		
MADAGASCAR	MAD	AFR			X
MALAWI	MAW	AFR			X
MALAYSIA	MAS	ASI			X
MALDIVES	MDV	ASI			X

MALI	MLI	AFR			X
MALTA	MLT	EUR	X		
MARSHALL ISLANDS	MHL	OCE			X
MAURITANIA	MTN	AFR			X
MAURITIUS	MRI	AFR			X
MEXICO	MEX	NAM	X		
MICRONESIA	FSM	OCE			X
MOLDOVA	MDA	EUR	X		
MONACO	MON	EUR	X		
MONGOLIA	MGL	ASI	X		
MONTENEGRO	MNE	EUR	X		
MONTSERRAT	MNT	NAM	X		
MOROCCO	MAR	AFR		X	
MOZAMBIQUE	MOZ	AFR			X
MYANMAR	MYA	ASI		X	
NAMIBIA	NAM	AFR			X
NEPAL	NEP	ASI			X
NETHERLANDS	NED	EUR	X		
NEW ZEALAND	NZL	OCE	X		
NICARAGUA	NCA	NAM			X
NIGER	NIG	AFR			X
NIGERIA	NGR	AFR		X	
NORFOLK ISLAND	NFI	OCE	X		
NORTH MACEDONIA	MKD	EUR	X		
NORTHERN MARIANA ISLANDS	NMI	OCE	X		
NORWAY	NOR	EUR	X		
OMAN	OMA	ASI	X		
PAKISTAN	PAK	ASI			X
PALESTINE	PLE	ASI			X
PANAMA	PAN	SAM			X
PAPUA NEW GUINEA	PNG	OCE			X
PARAGUAY	PAR	SAM	X		
PERU	PER	SAM	X		
PHILIPPINES	PHI	ASI			X
POLAND	POL	EUR	X		
PORTUGAL	POR	EUR	X		
PR OF CHINA	CHN	ASI	X		
PUERTO RICO	PUR	NAM	X		
QATAR	QAT	ASI	X		
Rep of NAURU - Pacific	NRU	OCE			X
Rep of PALAU - Pacific	PLW	OCE	X		
REPUBLIC Of YEMEN	YEM	ASI			X
ROMANIA	ROU	EUR	X		

RUSSIA	RUS	EUR	X		
RWANDA	RWA	AFR			X
SAINT KITTS AND NEVIS	SKN	NAM	X		
SAINT LUCIA	LCA	NAM			X
SAINT VINCENT & THE GRENADINES	VIN	NAM	X		
SAMOA	SAM	OCE			X
SAN MARINO	SMR	EUR	X		
SAUDI ARABIA	KSA	ASI		X	
SENEGAL	SEN	AFR			X
SERBIA	SRB	EUR			
SEYCHELLES	SEY	AFR	X		
SIERRA LEONE	SLE	AFR			X
SINGAPORE	SGP	ASI	X		
SLOVAK REPUBLIC	SVK	EUR	X		
SLOVENIA	SLO	EUR	X		
SOLOMON ISLANDS	SOL	OCE			X
SOMALIA	SOM	AFR			X
SOUTH AFRICA	RSA	AFR		X	
SOUTH SUDAN	SSD	AFR			X
SPAIN	ESP	EUR	X		
SRI LANKA	SRI	ASI			X
SUDAN	SUD	AFR			X
SURINAME	SUR	SAM	X		
SWEDEN	SWE	EUR	X		
SWITZERLAND	SUI	EUR	X		
SYRIA	SYR	ASI		X	
TAJIKISTAN	TJK	ASI			X
TANZANIA	TAN	AFR			X
THAILAND	THA	ASI			X
THE GAMBIA	GAM	AFR			X
TIMOR LESTE	TLS	ASI			X
TOGO	TOG	AFR			X
TONGA	TGA	OCE			X
TRINIDAD AND TOBAGO	TTO	NAM	X		
TUNISIA	TUN	AFR	X		
TURKEY	TUR	EUR	X		
TURKMENISTAN	TKM	ASI			X
TURKS AND CAICOS ISLANDS	TKS	NAM	X		
TUVALU	TUV	OCE			X
UGANDA	UGA	AFR			X
UKRAINE	UKR	EUR	X		
UNITED ARAB EMIRATES	UAE	ASI	X		

UNITED STATES	USA	NAM	X		
URUGUAY	URU	SAM	X		
UZBEKISTAN	UZB	ASI			X
VANUATU	VAN	OCE			X
VENEZUELA	VEN	SAM			X
VIETNAM	VIE	ASI			X
VIRGIN ISLANDS	ISV	NAM	X		
ZAMBIA	ZAM	AFR		X	
ZIMBABWE	ZIM	AFR			X

**WORLD ATHLETICS INDOOR CHAMPIONSHIPS – BELGRADE 2022
QUOTA**

Host Country	SRB
17 athletes	USA
14 athletes	GBR
10 athletes	AUS, BRA, FRA, GER
9 athletes	CAN, ITA, JAM, POL
8 athletes	ESP
7 athletes	JPN, NED, SUI
6 athletes	BEL, SWE
5 athletes	BLR, CHN, CUB, CZE, FIN, KEN, NOR, POR, RSA
4 athletes	ETH, GRE, IRL, NGR, NZL, UGA, UKR
3 athletes	BAH, HUN, ROU, SLO, TTO, TUR, UZB
2 athletes	ARG, BAR, BDI, BIH, BUL, BUR, CIV, COL, CYP, DOM, EGY, IND, ISR, KAZ, KUW, LTU, LUX, MAR, MEX, NAM, QAT, URU, VEN

All other Member Federations are given a quota of one athlete ONLY.

WORLD ATHLETICS INDOOR CHAMPIONSHIPS – BELGRADE 2022
TEAM OFFICIALS CHART

Athletes	Officials accommodated with the Team (55%)	Extra Officials (25%)	Athletes	Officials accommodated with the Team (55%)	Extra Officials (25%)
1	1	1	41	23	11
2	2	1	42	24	11
3	2	1	43	24	11
4	3	1	44	25	11
5	3	2	45	25	12
6	4	2	46	26	12
7	4	2	47	26	12
8	5	2	48	27	12
9	5	3	49	27	13
10	6	3	50	28	13
11	7	3	51	29	13
12	7	3	52	29	13
13	8	4	53	30	14
14	8	4	54	30	14
15	9	4	55	31	14
16	9	4	56	31	14
17	10	5	57	32	15
18	10	5	58	32	15
19	11	5	59	33	15
20	11	5	60	33	15
21	12	6	61	34	16
22	13	6	62	35	16
23	13	6	63	35	16
24	14	6	64	36	16
25	14	7	65	36	17
26	15	7	66	37	17
27	15	7	67	37	17
28	16	7	68	38	17
29	16	8	69	38	18
30	17	8	70	39	18
31	18	8	71	40	18
32	18	8	72	40	18
33	19	9	73	41	19
34	19	9	74	41	19
35	20	9	75	42	19
36	20	9	76	42	19
37	21	10	77	43	20
38	21	10	78	43	20
39	22	10	79	44	20
40	22	10	80	44	20

WORLD ATHLETICS INDOOR CHAMPIONSHIPS

BELGRADE, 18-20 MARCH 2022

NAME OF AWARD WINNER			
EVENT			
POSITION			
COUNTRY			
I would like my Belgrade World Athletics Indoor Championships' Award to be paid to <i>(please tick the box corresponding to your choice)</i>			
1. My Authorised Athletes' Representative	<input type="checkbox"/>	NAME::	
2. Me personally <i>(please provide details below)</i>	<input type="checkbox"/>		
3. My National Member Federation	<input type="checkbox"/>		
In case of choice 1 or 2 <i>(above)</i> , please fill in below in block letters the bank details hereunder			
BANK NAME			
BANK BRANCH ADDRESS <i>(street and number)</i>			
City		Country	
		Postal code	
ACCOUNT OWNER <i>(Beneficiary, pay to:)</i>			
ACCOUNT NUMBER			
IBAN CODE			
BANK CODE			
SWIFT CODE			
I confirm that I will make myself available for promotional activities as set out in the athlete agreement. I will be solely responsible for the payment of any taxes, duties and/or levies of any nature and will agree to hold World Athletics and its partner(s) harmless in this regard.			
Signature of the Athlete <i>(Digital signature allowed)</i>			
Please return this form before <u>20 April 2022</u> to World Athletics Email: awards@worldathletics.org			